

**FINGERPRINT
DOOR LOCK**

X1

Installation

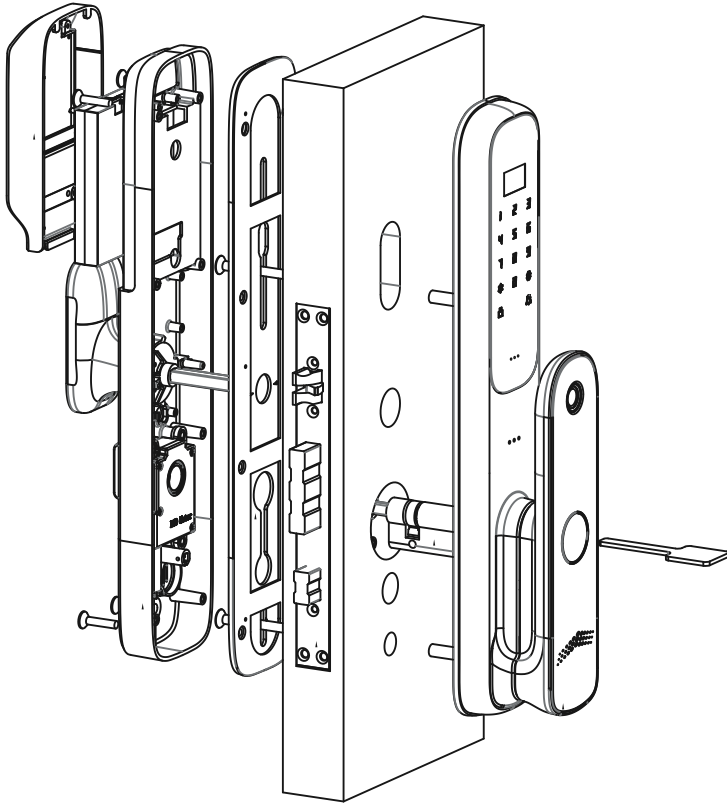

1. Mark the holes on the door according to the template, and then drill the holes.
2. Install the mortise and fasten it with screws. Install the strike box and strike and fasten them with screws.
3. Install the cylinder into the mortise and fasten it.
4. Install the connection rod on the front panel, and then install the front panel on the door.
5. Connect the cables from the front and back panels, and then install the spindle in the mortise. After that, install the whole back panel on the other side of the door, install the screws from the back panel and fasten them.
6. Open the battery cover and install the batteries.
7. Try to unlock the lock and confirm the installation is successful.
8. Try to use the key to unlock the lock, and make sure it works.

Product Guide

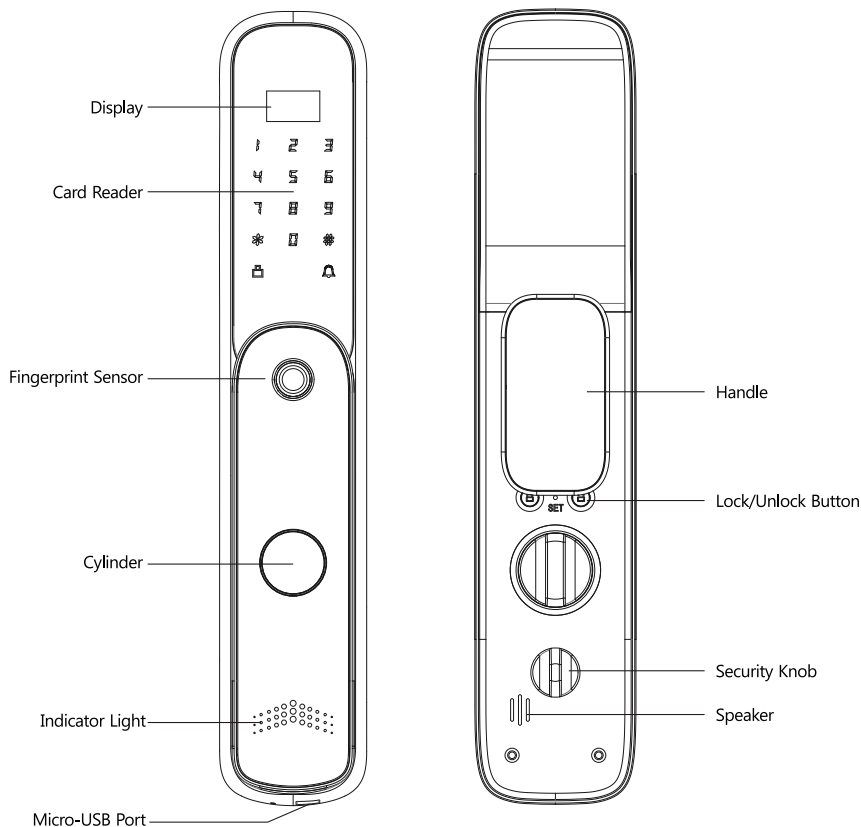

Introduction

1. There are up to 300 users available in the lock, which can be divided into 2 types:
 - a) Master User: ID from 001 to 009;
 - b) Normal User: ID from 010 to 300;
2. The password can be set with 6 to 10 digits. In factory default, the master password is 123-456;
3. There are single unlocking mode and double unlocking mode in the lock. Single unlocking mode is default.
4. There is voice introduction to help you understand the operations in the lock.
5. The lock will be locked for 5 minutes after inputting wrong password in 3 times.
6. When the battery voltage is low than 4.8V, the low battery alarm will be activated every time when unlock the lock.
7. There is a Micro-USB port at the bottom of the front panel as the emergency power supply port.
8. The Security bolt has to be unlocked from inside.

Operation

1 Some Suggestions to Help Capturing the Fingerprint

When placing the finger on the sensor, please make sure the “core” of fingerprint is staying in the main area of sensor directly with a little be pressure. Like the pictures show as following:
Insert Image

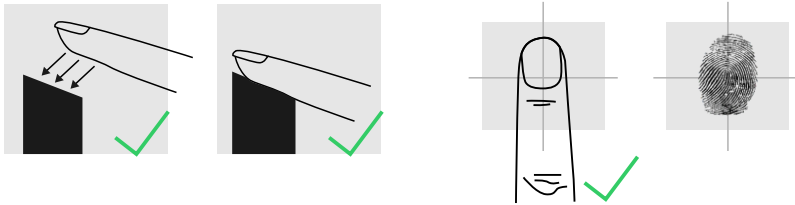

The sensor may not capture the correct fingerprint image if you take the following operations. Insert Image

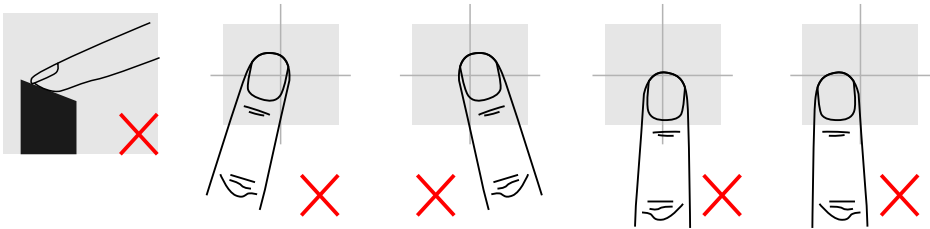

It is suggested to register the thumb, first finger, and middle finger for better fingerprint images.

2 Fingerprint Unlocking

Place the finger on the sensor, the lock will be activated automatically and started to capture the fingerprint image for identification. Once the identification is passed, the LCD shows the lock is unlocking, and the motor starts to turn the mortise to unlock.

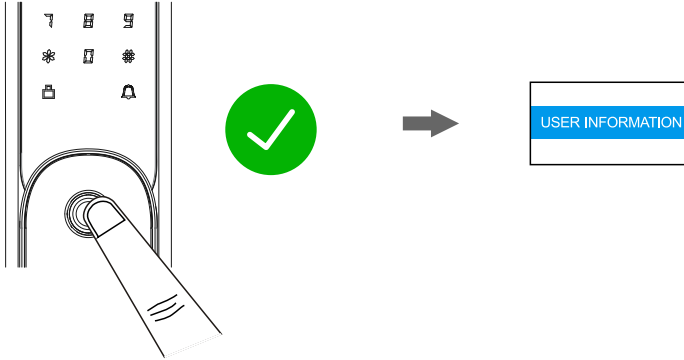

3 Password Unlocking

Touch the keypad to activate the lock, and then input the password (6-10 digits) with pressing “#” to finish. If the password is correct, the LCD shows the lock is unlocking, and the motor starts to turn the mortise to unlock.

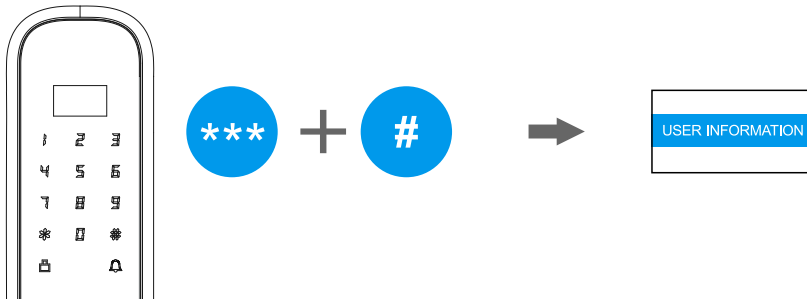

⚠ When inputting a wrong password for 3 times, the lock will be locked for 5 minutes. During the 5 minutes, the lock cannot be activated and all operations are not available. After that, the lock returns to normal state.

4 Random Password Protection

For a better security protection to the password user, the lock is designed with a random password protection. You can add any digits before and after the real password.

For example, the password is "1234-5678", you can unlock the lock by inputting the password as following:

- 1:

X	X	X	X	X	X	1	2	3	4	5	6	7	8	#
---	---	---	---	---	---	---	---	---	---	---	---	---	---	---
- 2:

1	2	3	4	5	6	7	8	X	X	X	X	X	X	#
---	---	---	---	---	---	---	---	---	---	---	---	---	---	---
- 3:

X	X	X	X	1	2	3	4	5	6	7	8	X	X	X	X	#
---	---	---	---	---	---	---	---	---	---	---	---	---	---	---	---	---

5 RF Card Unlocking

Place the card close to the card reader to verify, if the card is correct, the LCD shows the lock is unlocking, and the motor starts to turn the mortise to unlock.

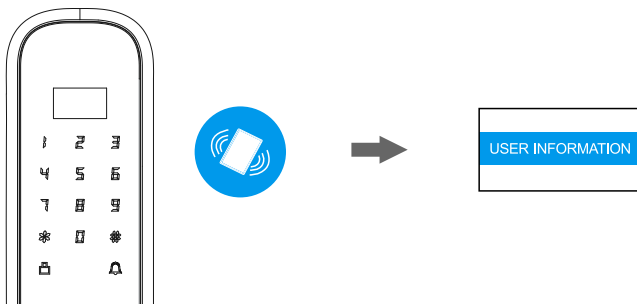

6 Mechanical Key Unlocking

When there is problem with electronic part, and the batteries run out of power, using mechanical key is the way to unlock the lock.

7 Register Master User

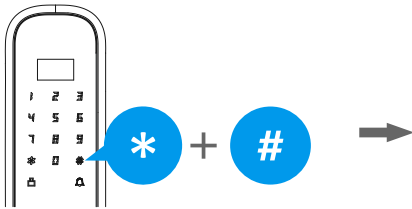

- a Press * and # key, and then input the master user information for authorization to log in the system

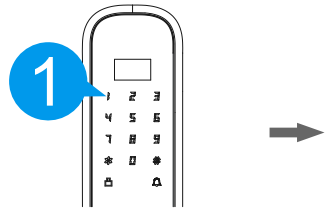

- b Select 1 for master user setting

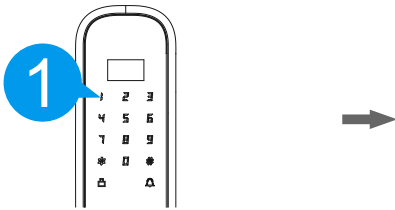

- c Select 1 to add new user

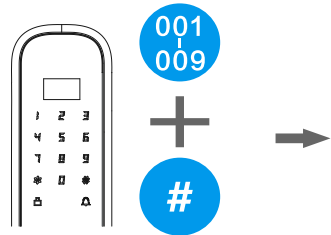

- d Input the ID number for the user (ID from 001 to 009), then press # to confirm

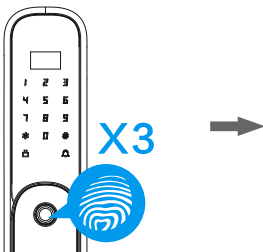

- e Fingerprint User: place the finger on the sensor in 3 times to register

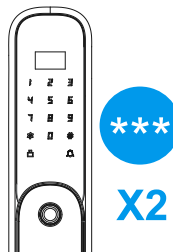

- f Password User: input the password in 2 times to register

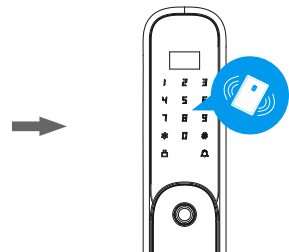

- g Card User: place the card on the reader to register

 **The default master password is 123-456;**

 **There are maximum 9 master users are available in the lock;**

 **The password can be set 6 to 10 digits;**

 **Please try to use the master user to unlocking to make sure the operations are successful.**

8 Register Normal User

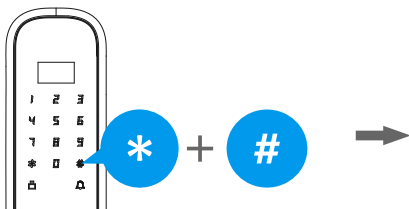

- a Press * and # key, and then input the master user information for authorization to log in the system

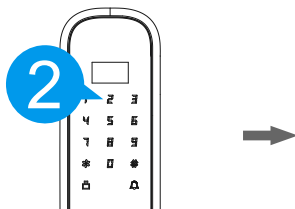

- b Select 2 for normal user setting

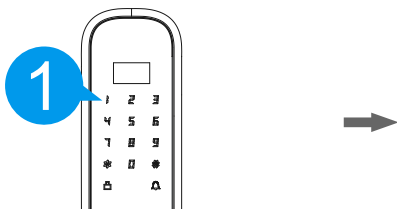

- c Select 1 to add new user

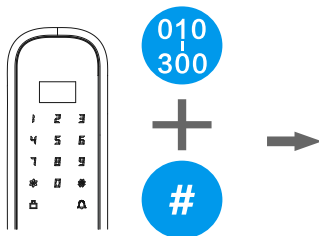

- d Input the ID number for the user (ID from 010 to 300), then press # to confirm

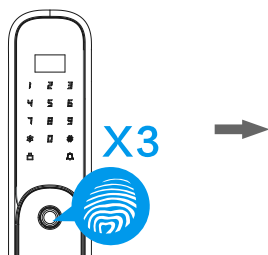

- e Fingerprint User: place the finger on the sensor in 3 times to register

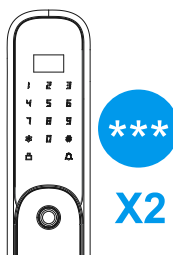

- f Password User: input the password in 2 times to register

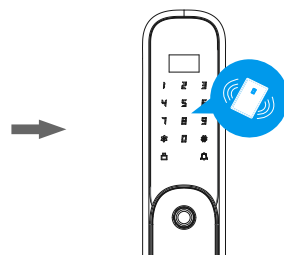

- g Card User: place the card on the reader to register



Please try to use the registered user to unlock and make sure the operations are successful.

9 Modify Master User

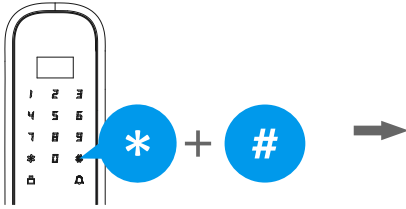

a Press * and # key, and then input the master user information for authorization to log in the system

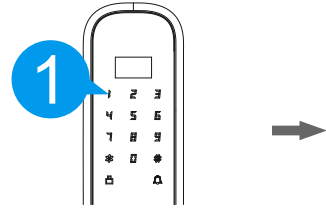

b Select 1 for master user setting

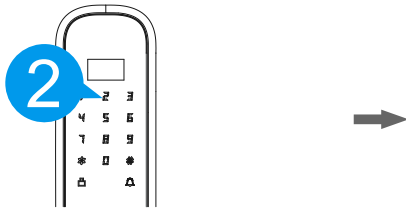

c Select 2 to modify the user

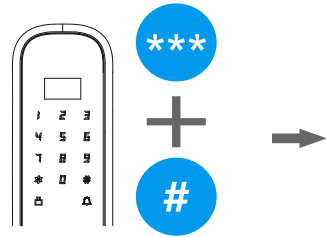

d Input the ID number you want to modify, then press # to confirm

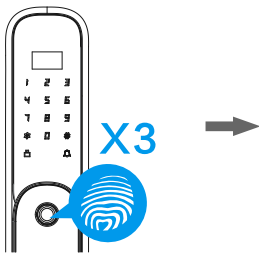

e Fingerprint User: place the finger on the sensor in 3 times to register

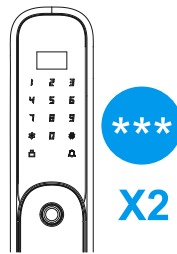

f Password User: input the password in 2 times to register

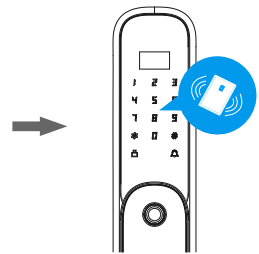

g Card User: place the card on the reader to register

! *Modify the users mean to change the unlocking method or password for the users;*

! *Please try to use the modified user to unlock and make sure the operations are successful.*

10 Modify Normal User

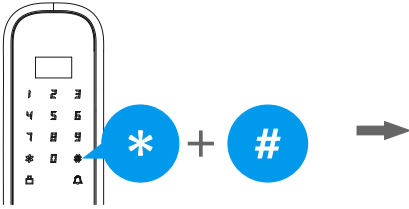

a Press * and # key, and then input the master user information for authorization to log in the system

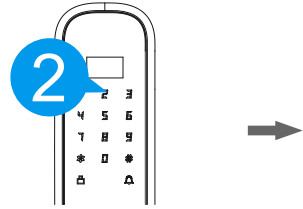

b Select 2 for normal user setting

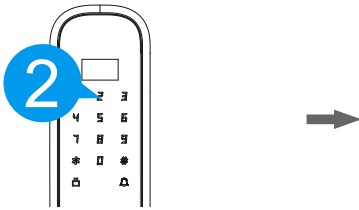

c Select 2 to modify the user information

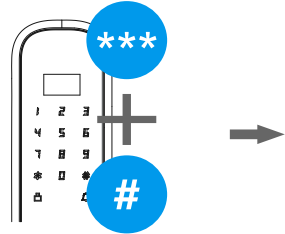

d Input the ID number you want to modify, then press # to confirm

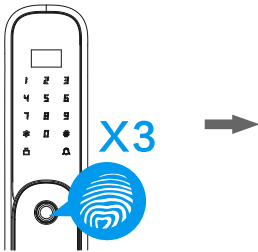

e Fingerprint User: place the finger on the sensor in 3 times to register

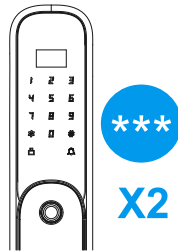

f Password User: input the password in 2 times to register

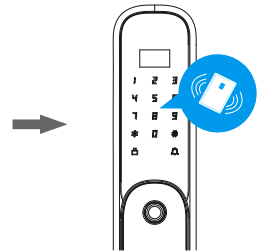

g Card User: place the card on the reader to register

 **Modify the users mean to change the unlocking method or password for the users;**

 **Please try to use the modified user to unlock and make sure the operations are successful.**

11 Delete Master User

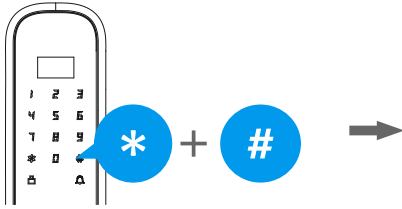

a Press * and # key, and then input the master user information for authorization to log in the system

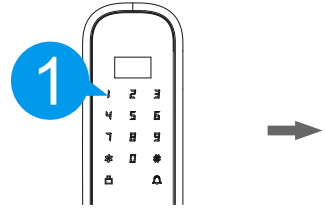

b Select 1 for master user setting

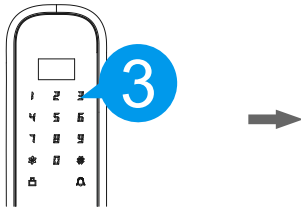

c Select 3 to delete the user information

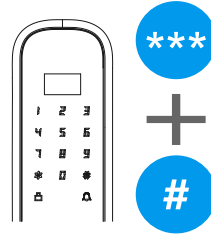

d Input the ID number you want to delete, then press # to confirm



Please try to use the deleted user to unlock and make sure the operations are successful.

12 Delete Normal User

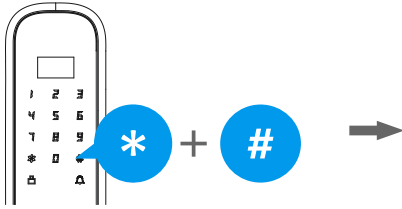

- a Press * and # key, and then input the master user information for authorization to log in the system

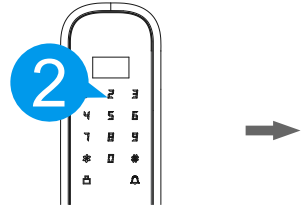

- b Select 2 for normal user setting

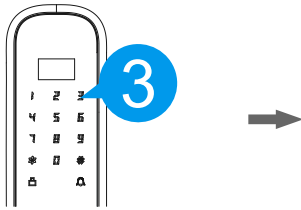

- c Select 3 to delete the user information

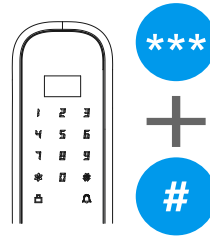

- d Input the ID number you want to delete, then press # to confirm



Please try to use the deleted user to unlock and make sure the operations are successful.

13 Double Unlocking Mode

For better security, you can set up the lock to double unlocking mode. When the lock is under double unlocking mode, you have to input 2 registered users every time for unlocking.

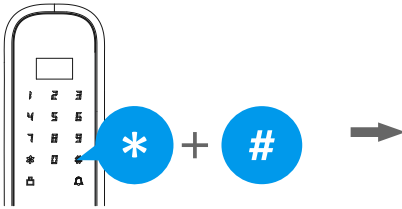

- a Press * and # key, and then input the master user information for authorization to log in the system

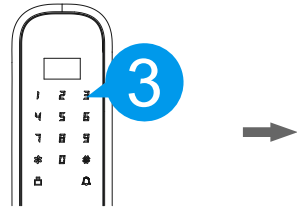

- b Select 3 for system setting

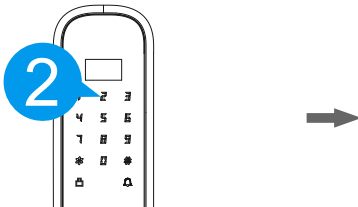

- c Select 2 for unlocking mode



- d Select 2 for double unlocking mode (1 is for single unlocking mode)

! *During the lock is under double unlocking mode, you have to input 2 registered users every time to unlock.*

! *If you want to switch to single unlocking mode, please follow the operations above, and then select 1 for single unlocking mode at the last.*

14 Date and Time Setting

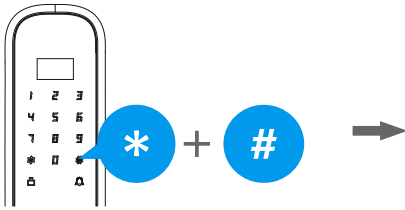

a Press * and # key, and then input the master user information for authorization to log in the system

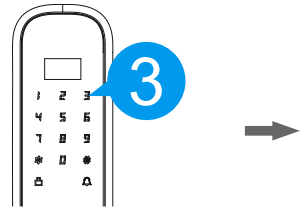

b Select 3 for system setting

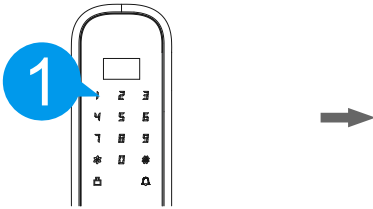

c Select 1 for date and time setting

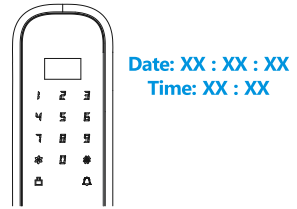

d Input the correct date and time for the lock

15 Unlock Record

The lock can keep up to 6,000 the latest unlock records, which you can track the access from the LCD.

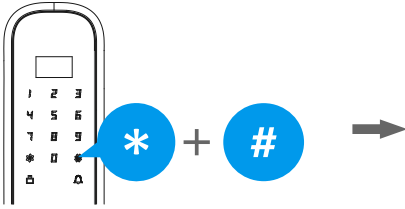

- a Press * and # key, and then input the master user information for authorization to log in the system

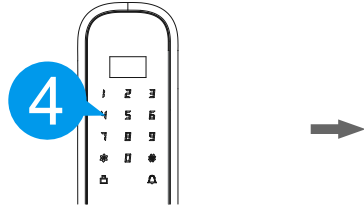

- b Select 4 for unlock record

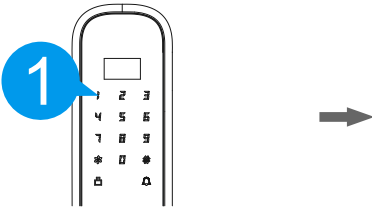

- c Select 1 for checking the records

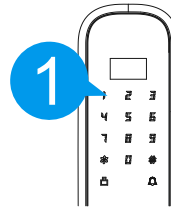

- d Select 1 to check the unlock records

16 Restore to Factory Default

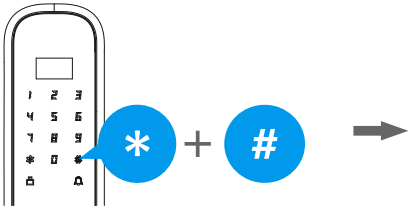

- a Press * and # key, and then input the master user information for authorization to log in the system

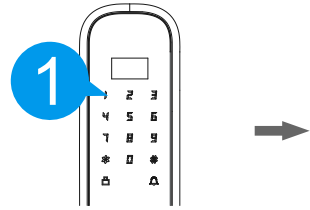

- b Select 1 for master user setting

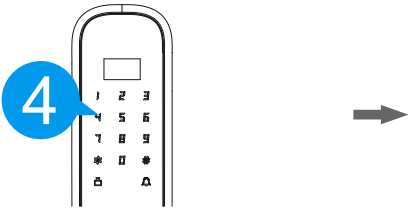

- c Select 4 to reset the lock

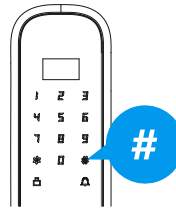

- d Press # to confirm and the lock starts to reset

 **When the lock is reset to factory default, any fingerprint and password can unlock;**

 **The master password will be reset to "123-456".**

17 Tuya Wi-Fi Setting

1. Download and install the APP on the mobile phone.
2. Select the "Security & Sensors" – "Lock (Wi-Fi)"

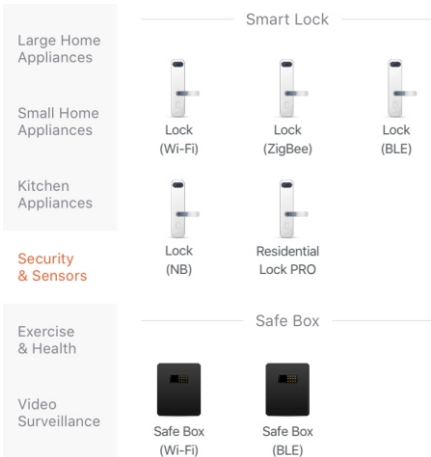

3. Select the Wi-Fi, and input the password for the Wi-Fi;

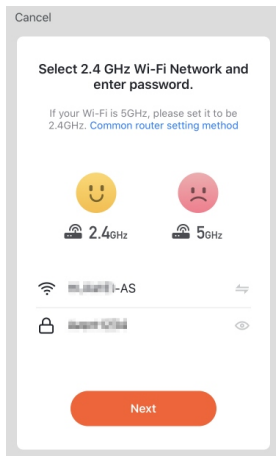

4. Make the connection is "EZ Mode", and click next

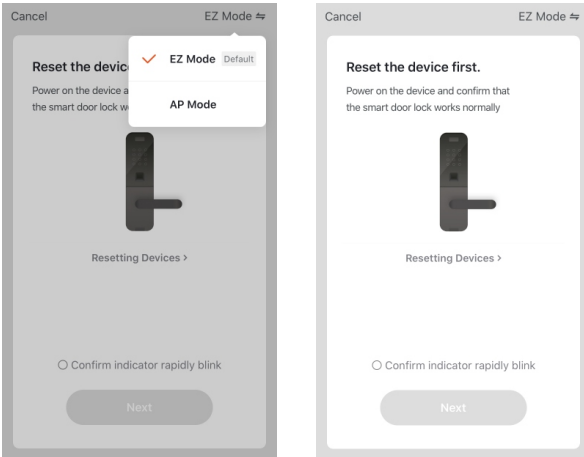

5. Log in the lock system, input 2 for user setting, input 4 for manage wireless, input 1 to add Wi-Fi, input 1 and select the Wi-Fi mode

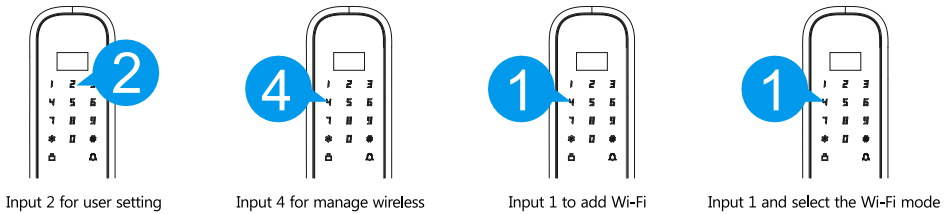

6. Wait some time and the APP will finish the connection with the lock automatically.
You can give a name for the lock to manage it easily.

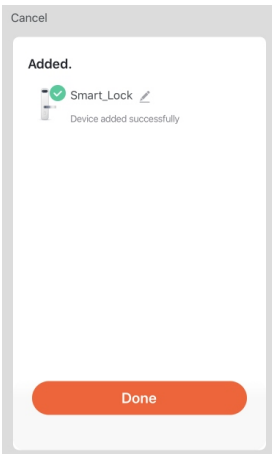

11 Remote Unlock

1. Activate the lock, and input 3+# to send the unlock request to the APP;

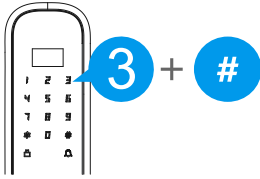

Input 3+# to send the unlock request to the APP

2. The APP will receive a message with unlock request

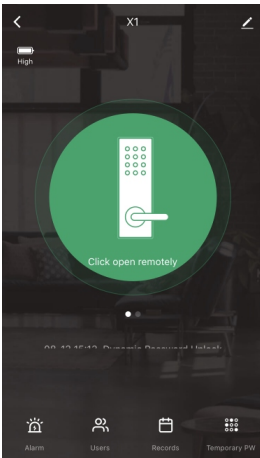

3. Confirm the request to unlock

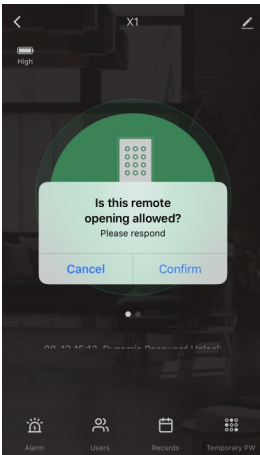

12 Temporary Password Unlock

1. Select the "Temporary PW" option;

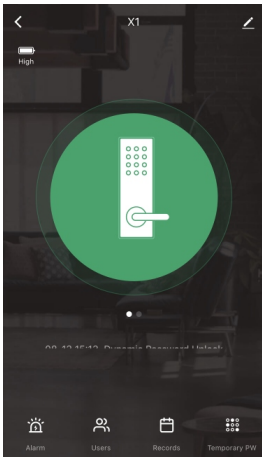

2. Select "Add" to generate the password;

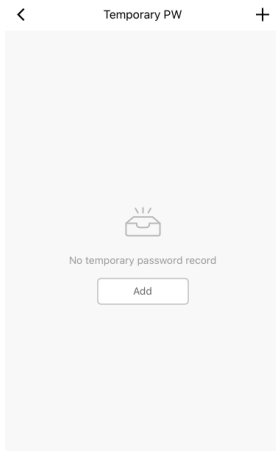

3. Input the password you want, or just click "Get Randomly" to generate the password;

< Temporary Code Setting Done

Please enter temporary password

--	--	--	--	--	--	--	--	--	--

Get Randomly

Name

Please set the password name

Effect of time

Please set the effective time

The failure time

Please set the expiration time

4. Input the Name, Effect of time, Expire of time, and then click done to save the setting;

< Temporary Code Setting Done

Please enter temporary password

--	--	--	--	--	--	--	--	--	--

Get Randomly

Name

Please set the password name

Effect of time

Please set the effective time

The failure time

Please set the expiration time

5. Activate the lock and synchronize the temporary the password to the lock

6. Use the password to unlock as daily.



After generate the password, make sure the password is synchronized to the lock

13 Remote Dynamic Password Unlock

1. Move to the interface of dynamic password;

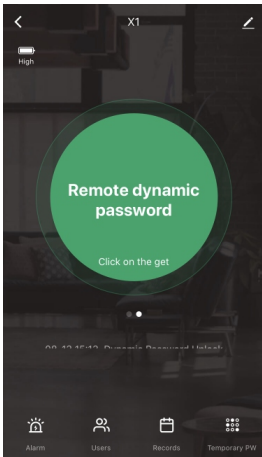

2. Click and icon and generate the password

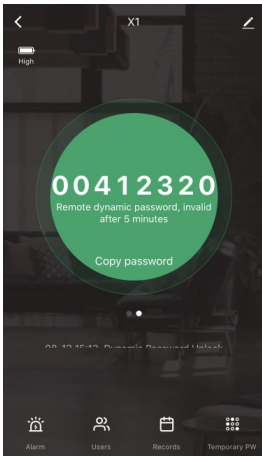

3. Use the password to unlock

 ***The password is only available in 5 minutes.***